

# SureStrike™

## Laser Training For Shotgun



The SureStrike™ 9mm Laser Cartridge allows you to train with your shotgun in complete safety at any location without using live ammunition. This high quality tool provides a safe, realistic and economical training environment for all user levels.

This package includes:

- 12G Adapter only
- 12G Hunting pack (Adapter with 9mm Cartridge)
- 20G Adapter only
- 20G Hunting Pack (Adapter with 9mm Cartridge)

3 Reflective Targets included only with Hunting Packs with red Laser.

*We make shooters better! Spend less effort, time, and money by practicing with today's best personal training system anytime, anywhere!*

This product is patented under the USA patent law.  
The User is hereby placed on notice of Laser Ammo rights as listed on [www.laserammo.com](http://www.laserammo.com)

Product of Laser Ammo USA Inc.  
Phone: 516-858-1262 (U.S.)  
Proudly Made In Israel | Assembled in USA  
[www.laserammo.com](http://www.laserammo.com)



■ Red Laser    ■ IR Laser



User Guide Inside

Shotgun

# SureStrike™

## Laser Training For Shotgun



SAFETY



IMPROVES  
ACCURACY



FIRING PIN  
ACTIVATED



NO VIBRATION  
SENSITIVITY

• Marksmanship • Speed • Tracing • Trigger pull



## Instructions

### Step 1 - Safety

Unload the weapon

Physically and visually inspect the chamber, bore, and magazine well to ensure that all ammunition has been removed.

Store ammunition in an area that is separate from your training area.

It is recommended to lightly lubricate the adapter's o-ring before use.

 **Always personally verify that all ammunition has been removed before training.**

### Step 2 - Installation

1. Unscrew the laser cartridge and insert the battery pack according to the picture (flat side facing up). Reassemble the laser cartridge carefully. Verify the threading is fully closed and that there is no gap (pic 1)

2. Open the Shotgun Adapter by unscrewing the adapter cap. Insert the cartridge into the body of the adapter and reassemble the adapter by screwing the cap back on and tightening gently (pic 2)

3. Open the chamber of the shotgun, insert the Shotgun adapter as you would insert a single cartridge (pic 3)

Using your finger or the back end of a pencil, rotate the adapter and align the grooves on the adapter's cap to be positioned in the chamber so that the weapon's extractor will NOT come in contact with the adapter while cycling.

### Step 3 - Removal

4. Open the chamber (pic 4)

5. Using your finger or the back end of a pencil, rotate the Shotgun Adapter by pushing the grooves on the adapter's cap until it is aligned in the chamber so that the weapon's extractor WILL come in contact with the adapter's rim (pic 5) Cycle the weapon over a soft surface to eject the adapter. Remove the Laser Bullet from the adapter.

Remove the battery from the laser cartridge when not in use.

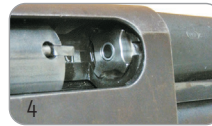
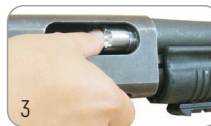

Using the SureStrike™ Laser Cartridge not according to the user guide will void the warranty.

No liability is expressed or implied for damage or injury as a result of installation or use of this product.

Warranty is limited to the replacement or repair of the original product only.